

## Alternative A

1. Lift up the rope clutch lever. Mark holes,  $c-c = 79 \text{ mm}$  (3.11 in), for the M6 machine screws and drill.
2. Apply sealant around the holes. Place Rutgerson cup washers over the sealant.
3. Push the M6 screws into the rope clutch holes, through the sealing washers and into the drilled holes.
4. Fit washers and tighten nuts on the underside of the deck.

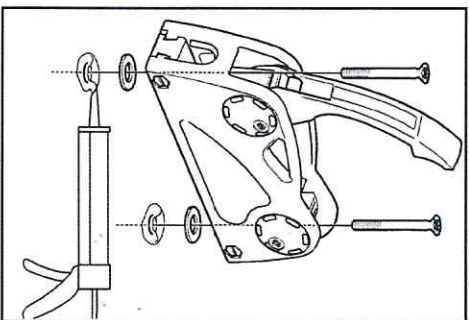

## Alternative B

1. Loosen the base plate by removing the two M5 allen screws. Then slide off the bottom plate. Mark the holes,  $c-c = 79 \text{ mm}$  (3.11 in), for the M6 machine screws and drill.
2. Apply sealant around the holes. Place Rutgerson cup washers over the sealant.
3. Push the M6 screws into the base plate holes, through the sealing washers and into the drilled holes.
4. Fit washers and tighten nuts on the underside of the deck.
5. Slide the body of the rope clutch onto the base plate and tighten the two M5 allen screws.

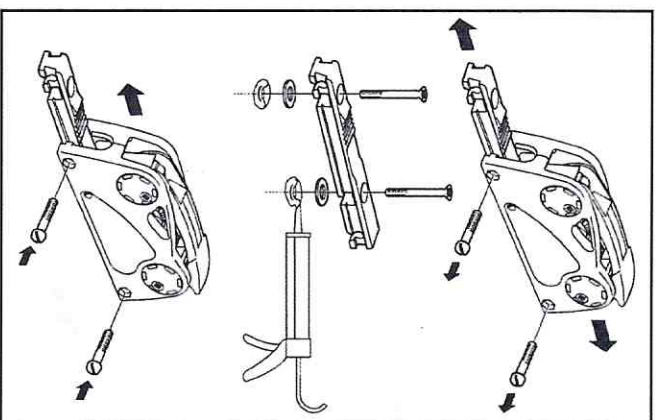

## Alternative C

1. Loosen the base plate by removing the two M5 allen screws. Then slide out the base plate. Mark the holes,  $c-c = 79 \text{ mm}$  (3.11 in) for the bolts (stainless steel M6 bolts with hexagonal heads) and drill.
2. Push the heads of the M6 hexagonal bolts into the grooves on the base plate. Then slide the base plate back into the body of the rope clutch and tighten with the two M5 allen screws.
3. Apply sealant around the drilled out holes. Place Rutgerson cup washers over the sealant.
4. Push the M6 bolts (now attached to the rope clutch) through the sealing washers and into the drilled holes.
5. Fit washers and tighten nuts on the underside of the deck.

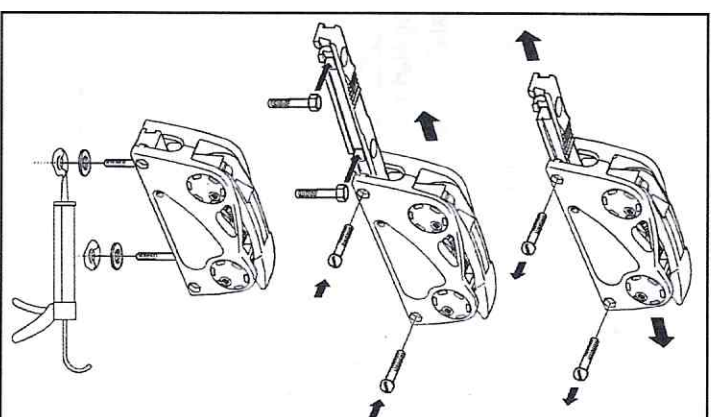

Rutgerson Marin AB ©  
 Mjölkekilsgratan 21,  
 442 66 Marstrand, Sweden  
 Phone: +46 (0) 303 20 66 50  
 Fax: +46 (0) 303 608 89  
 www.rutgerson.se  
 E-mail: postmaster@rutgerson.se

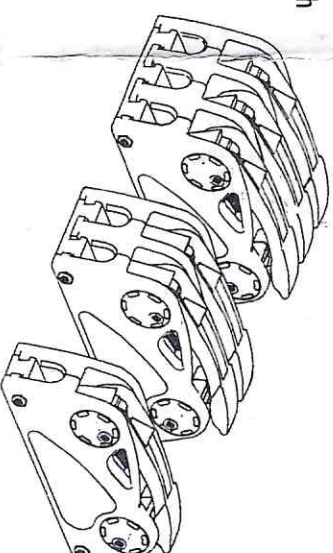

# Instructions for Rutgerson Rope Clutch RC 750HPX & RC 75X